

# **WHIP INDUSTRIES, INC.**

## **WRJK-06**

### **ROLLING AIR JACK**

### **PARTS BREAKDOWN**

**WHIP INDUSTRIES, INC**  
3010 S MAIN ST.  
FORT WORTH, TEXAS 76110  
PH (800) 256-7391 FAX (817) 289-1412  
E-MAIL: **WhipInd@whipindustries.com**

Rev.

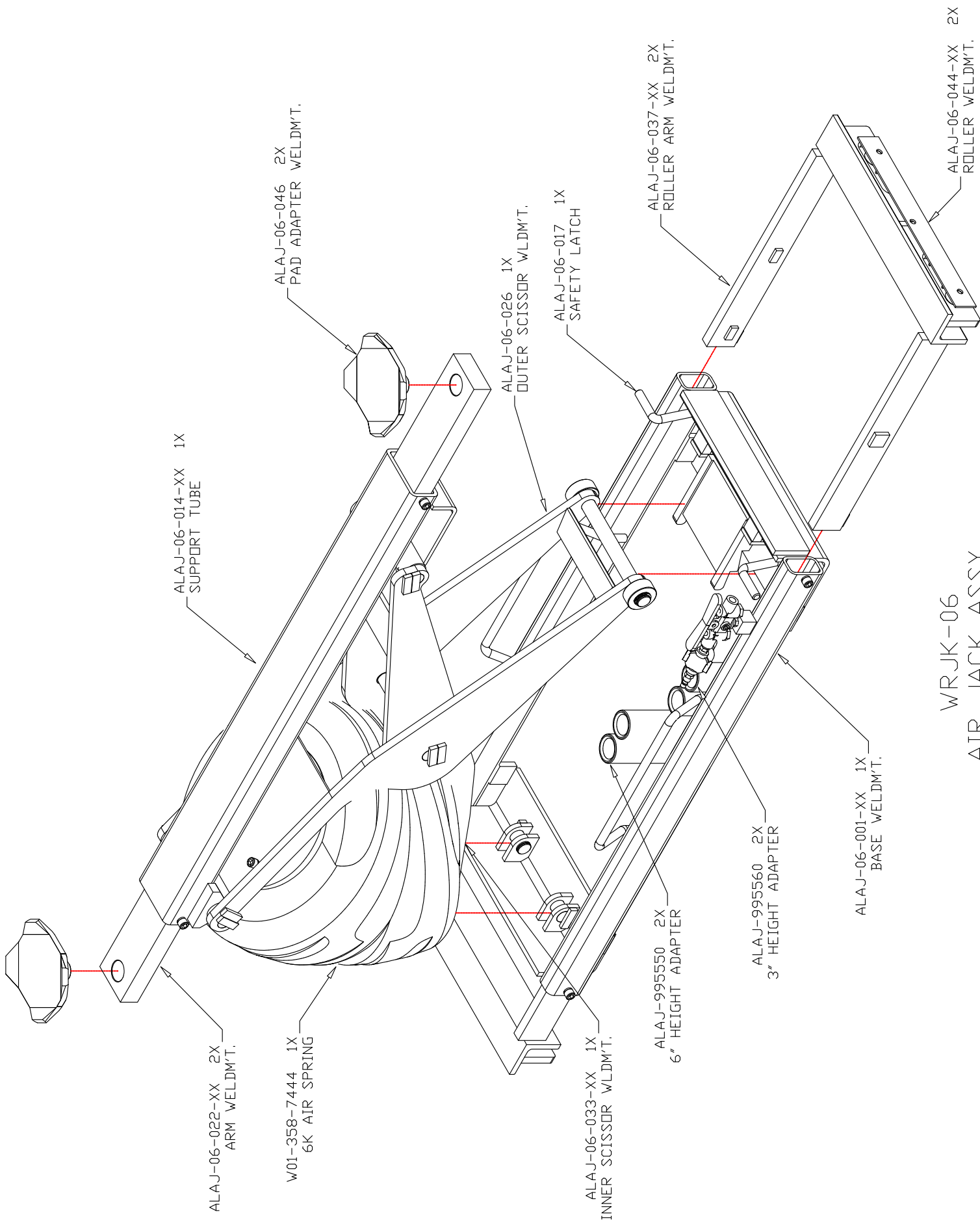

WRJK-06  
 AIR JACK ASSY.

ALAJ-06-037-XX 2X  
ROLLER ARM WELDM'T.

ALAJ-09-040 2X  
LOWER PIVOT PIN

98410A131 2X  
7/8 EXT. RETAINER RING

ALAJ-06-001-XX 1X  
BASE WELDM'T.

ALAJ-06-017-XX 1X  
SAFETY LATCH

91251A540 4X  
1/4-20UNC SHCS 3/4  
91102A029 4X  
1/4 LOCK WASHER

ALAJ-995550 2X  
6" HEIGHT ADAPTER

ALAJ-995560 2X  
3" HEIGHT ADAPTER

PNEUMATIC ASSY. 1X

ALAJ-06-051-XX 2X  
SAFETY LATCH COVER

91251A619 2X  
3/8-16UNC SHCS X 1/2

ALAJ-06-044-XX 2X  
ROLLER WELDM'T.

91102A031 2X  
3/8 LOCK WASHER

WRJK-06  
BASE ASSY.

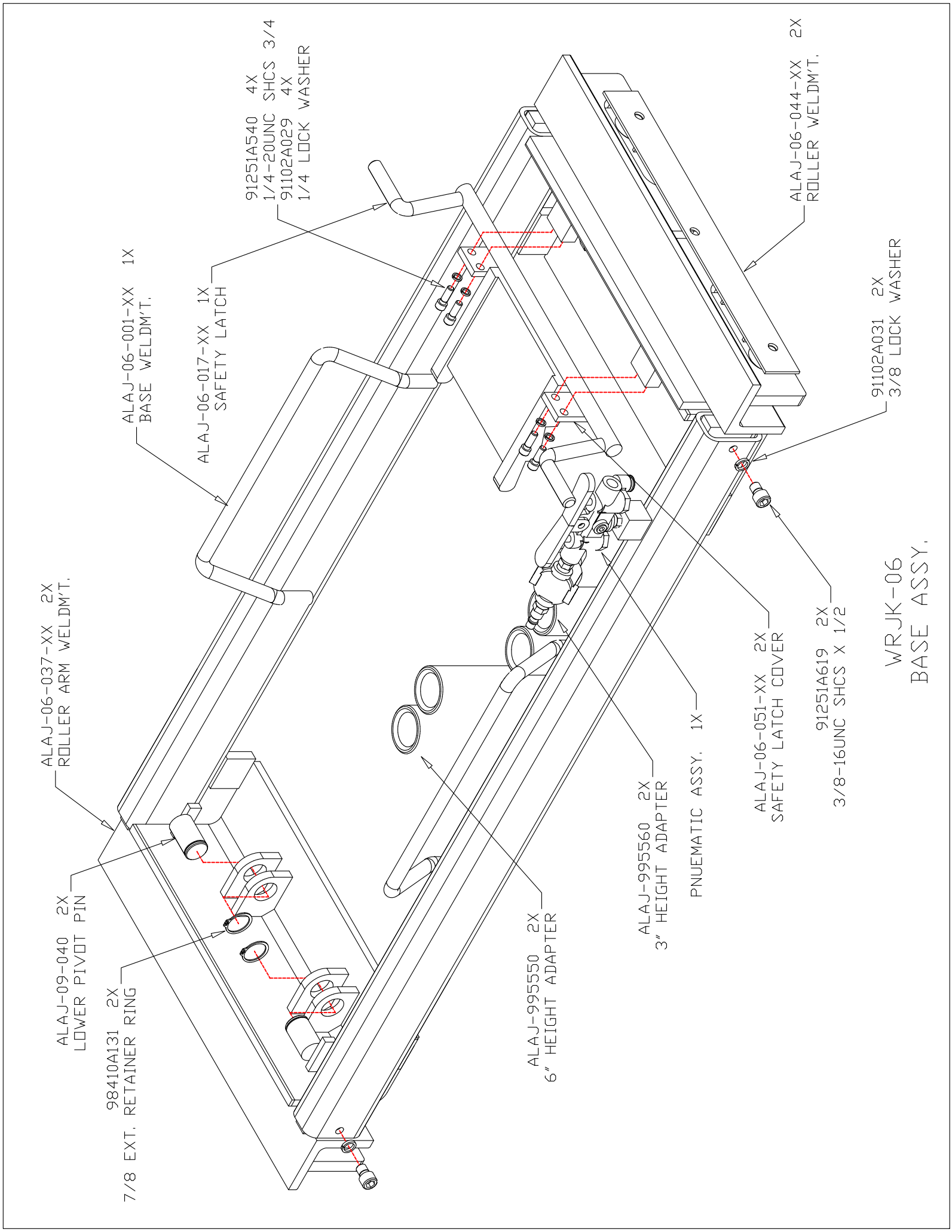

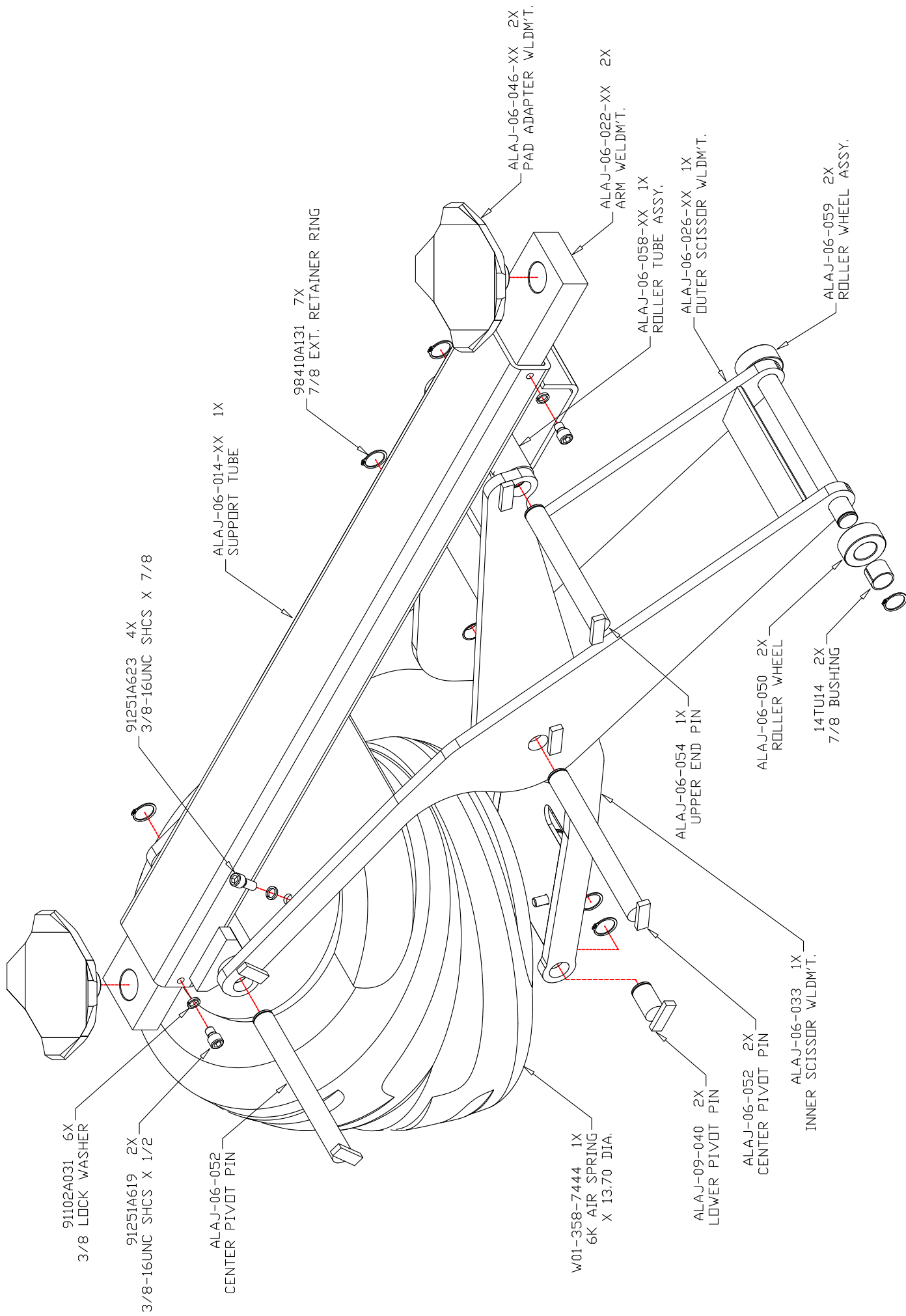

WRJK-06  
UPPER ASSEMBLY

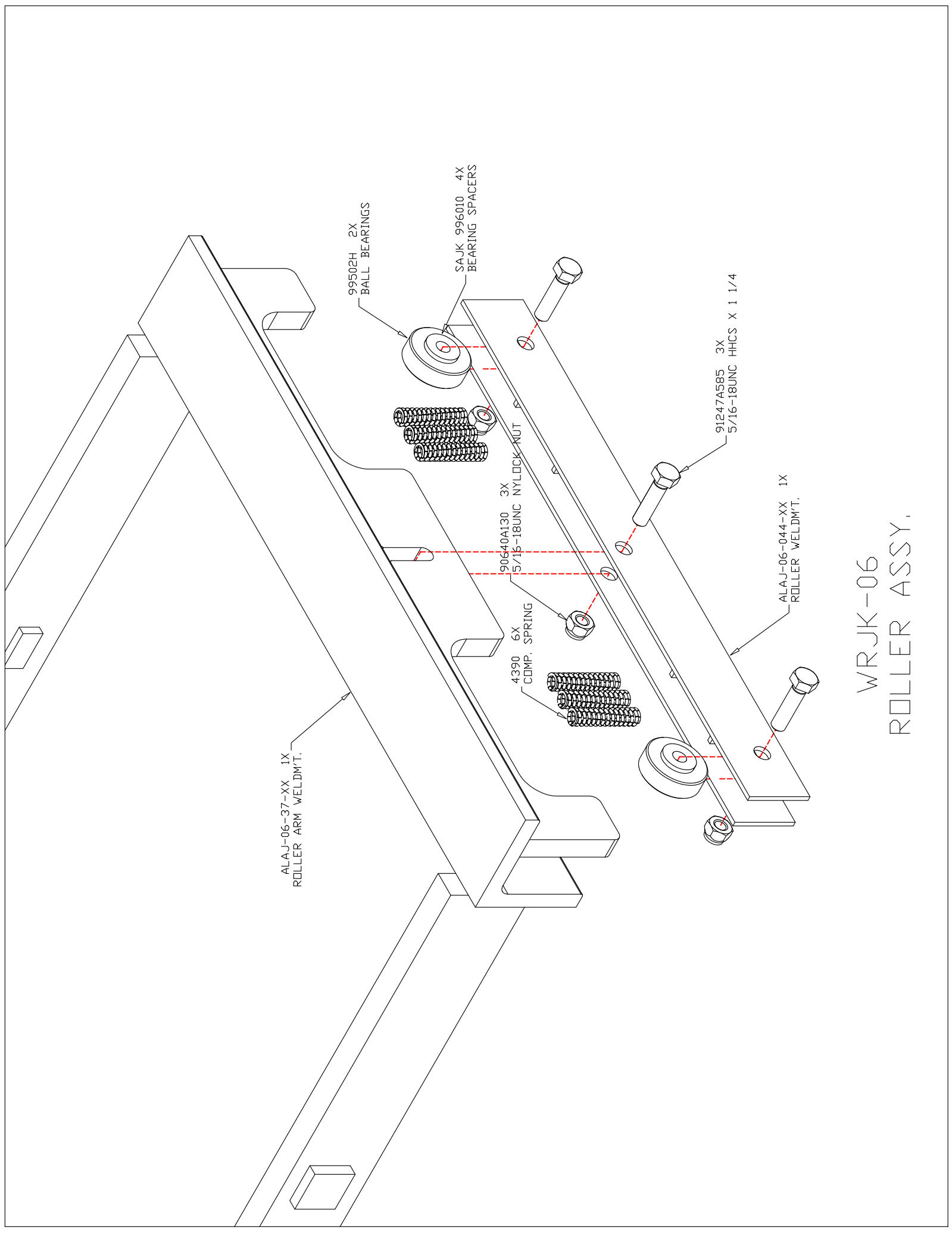

ALAJ-06-37-XX 1X  
ROLLER ARM WELDMT.

99502H 2X  
BALL BEARINGS

SAJK 996010 4X  
BEARING SPACERS

90640A130 3X  
5/16-18UNC NYLOCK NUT

4390 6X  
COMP. SPRING

91247A585 3X  
5/16-18UNC HHCS X 1 1/4

ALAJ-06-044-XX 1X  
ROLLER WELDMT.

WRJK-06  
ROLLER ASSY.

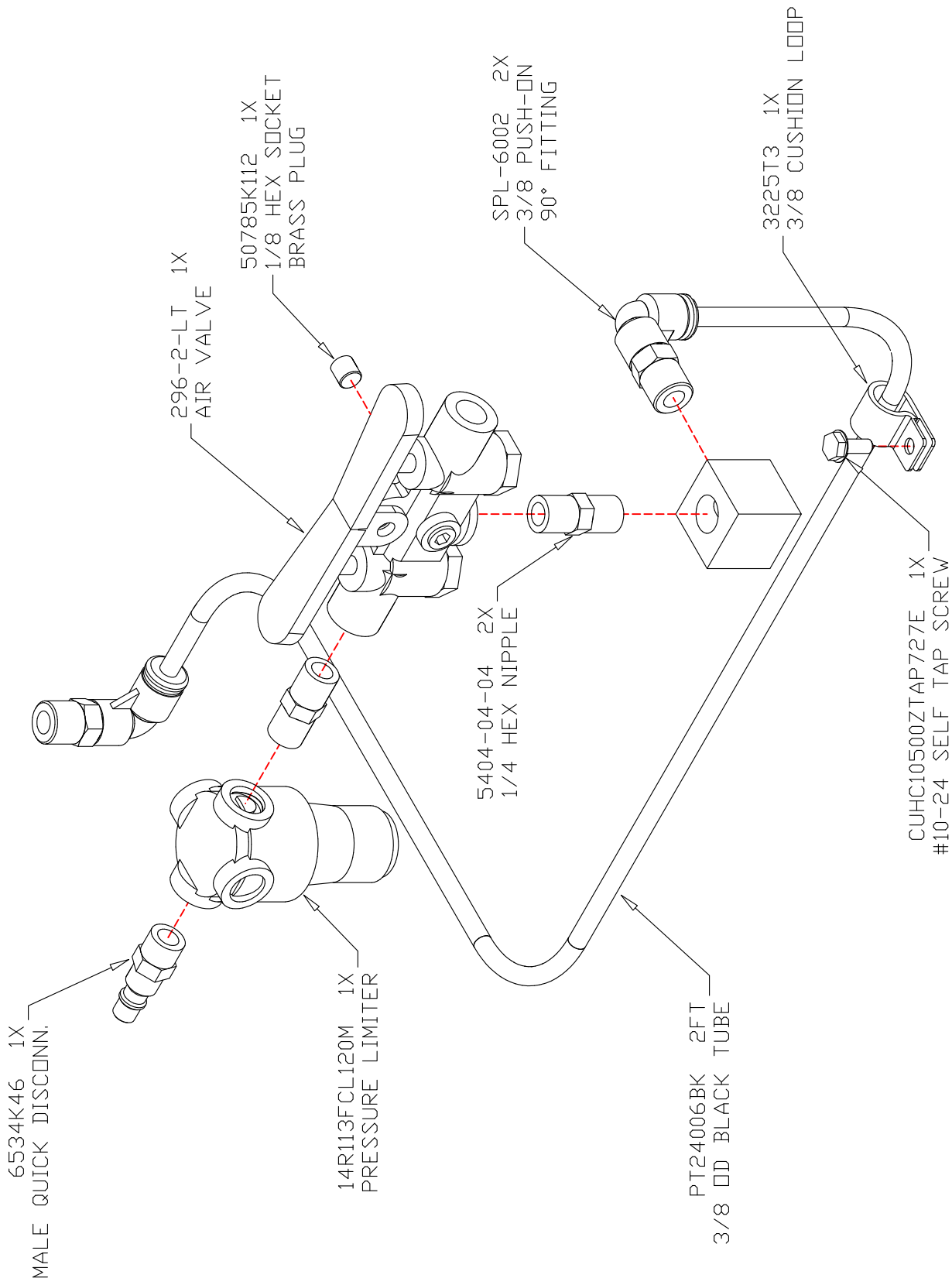

WRJK-06 & WRJK-08  
PNEUMATIC ASSY.

# ROLLING BRIDGE JACK WRJK-06 & WRJK-08

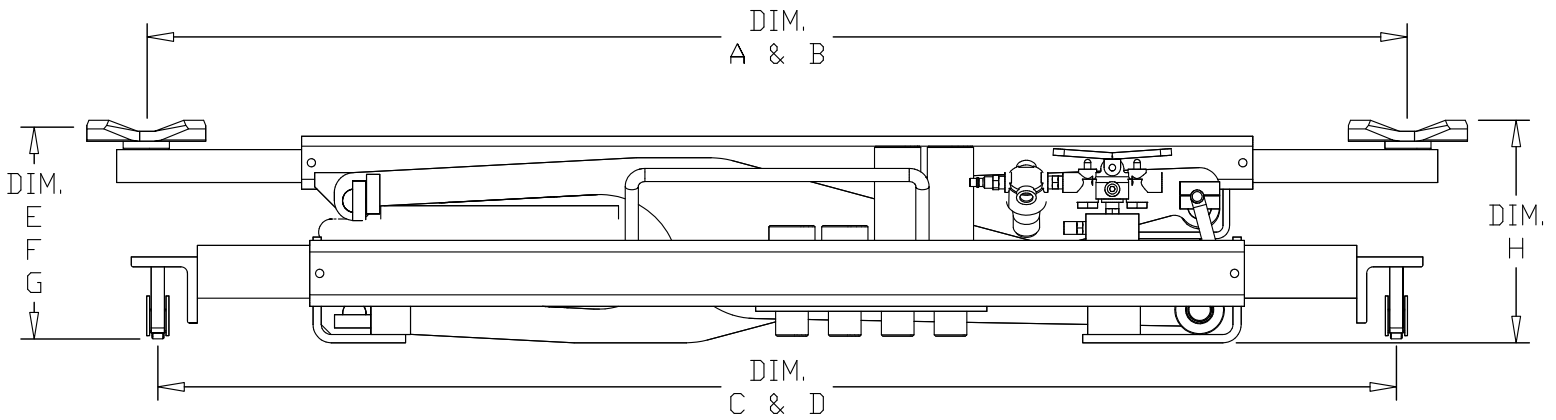

## SPECIFICATIONS

MODEL NO.	WRJK-06	WRJK-08
A. Arms Extended	53 3/4	53 3/4
B. Arms Retracted	39 3/4	39 3/4
C. Axles Extended	53	52
D. Axles Retracted	39	40
E. Raised Height	18 1/4	18 1/2
F. Raised Height w/3" Adapter	21 1/4	21 1/2
G. Raised Height w/6" Adapter	24 1/4	24 1/2
H. Collapsed Height	8	8 1/4
Jack Depth	15 3/4	19
Shipping Weight	275 lbs.	340 lbs.
Capacity	6,000 lbs.	8,000 lbs.

- \* All Rolling Jacks come with two standard 3" and 6" adapters.
- \* Rolling Jacks have built-in adapter holders.
- \* 110psi to 120psi required.